

Application

TYPICAL APPLICATION - APPLIED MUNTINS, FACTORY GLAZED IN SASH.

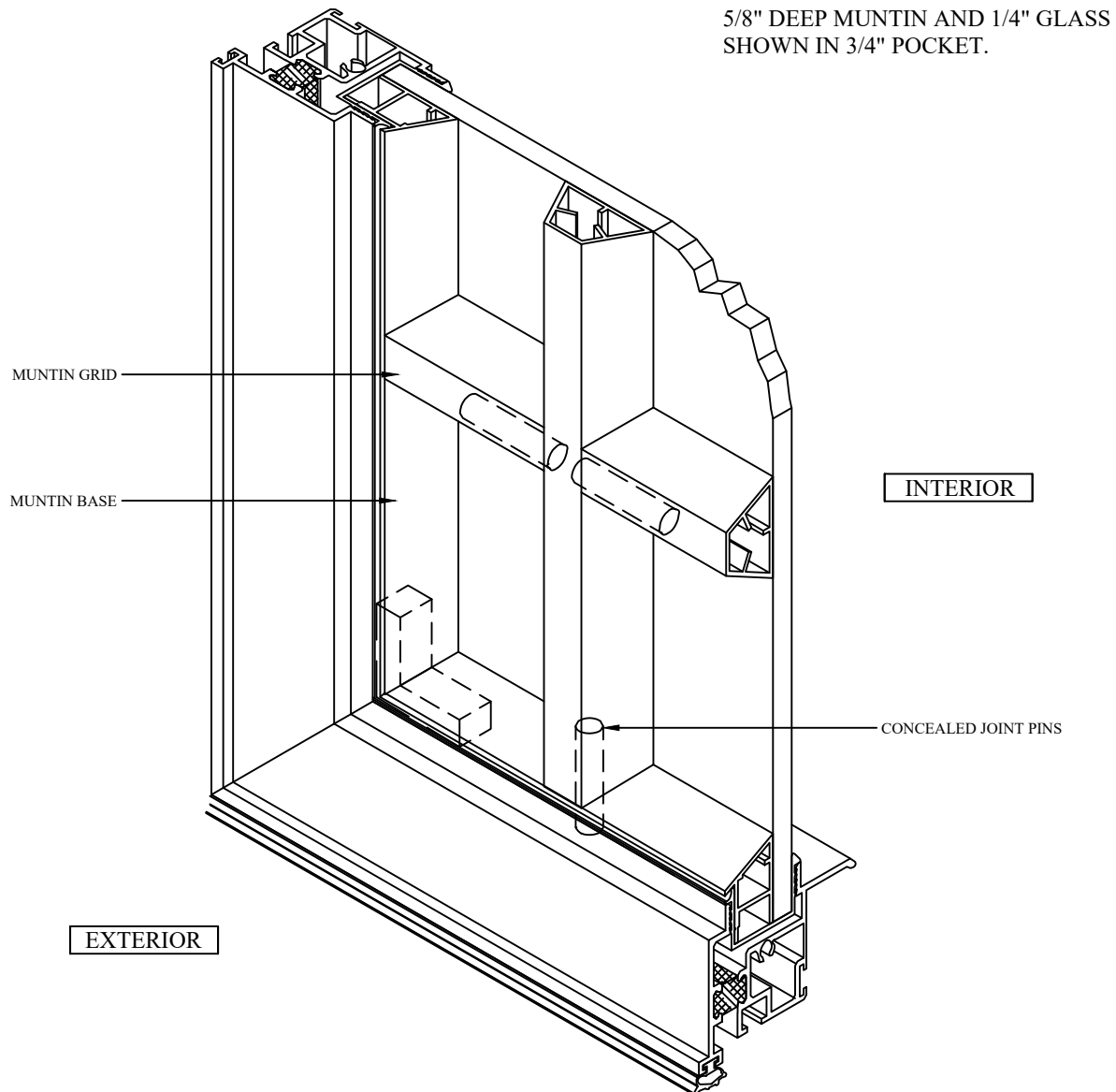

GLASS LITE CLOSEST TO THE GRID SHOULD BE TEMPERED TO RESIST
POTENTIAL THERMAL STRESS GLASS BREAKAGE.
CONSULT KAWNEER FOR RECOMMENDATIONS

RECOMMENDED MAXIMUM SASH SIZES:

11 Sq. Ft. IF 3/4" POCKET WITH MUNTIN & 1/4" MONOLITHIC GLASS.
19 Sq. Ft. IF 1" POCKET WITH MUNTIN & 1/2" INSULATING GLASS.

Terminology/Index

MUNTIN BASE TERMINOLOGY

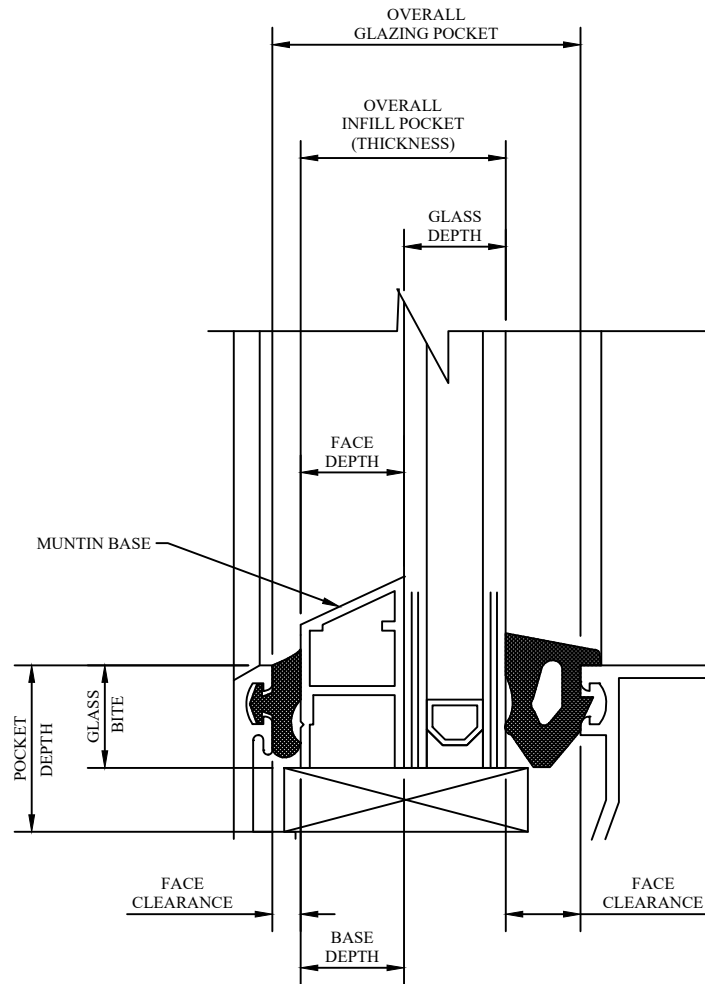

MUNTIN / MUNTIN BASE & SASH DIVIDERS INDEX

Muntin	Page
H-080	4
H-081	6
H-082	6
H-083	6
H-094	4
H-1367	5
H-1499	4
H-1525	4
H-1526	4
H-153	4
H-1532	4
H-1539	4
H-1558	5
H-1642	5
H-1683	5
H-1690	5
H-1877	5
H-1906	5
H-2330	5

Muntin	Page
H-2331	5
H-2729	5
H-2826	5
H-2844	4
H-3051	5
H-329	5
H-340	5
H-3462	6
H-374	5
H-982	6
H-983	5
Internal grids	6
S-1618	7
S-1675	7
S-1762	7
S-549	7
S-926	7
S-929	7

Half Scale Sections

**MUNTIN BASE
APPLICATIONS**

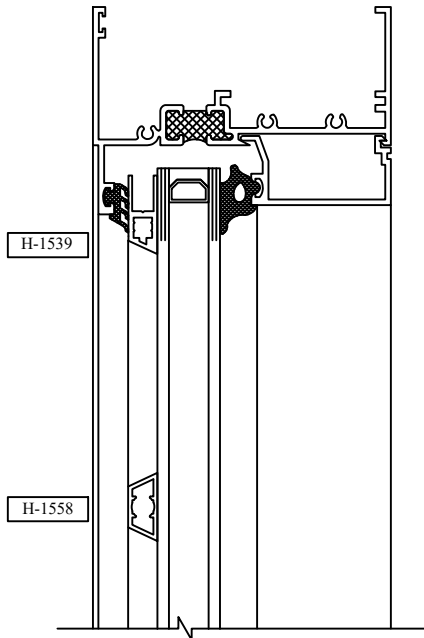

DRY GLAZING-INTERIOR SET

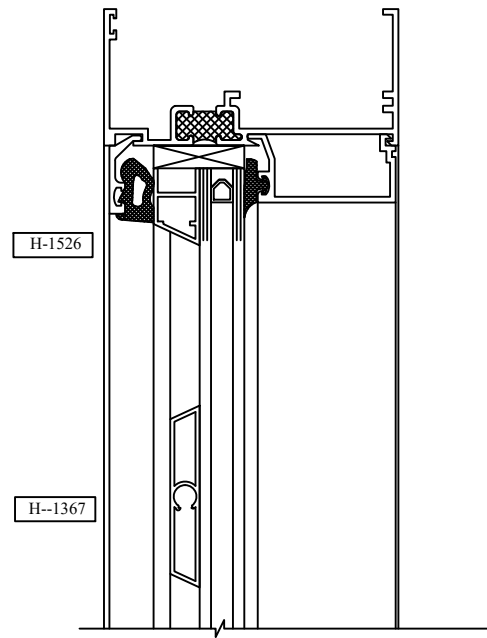

DRY GLAZING-EXTERIOR SET

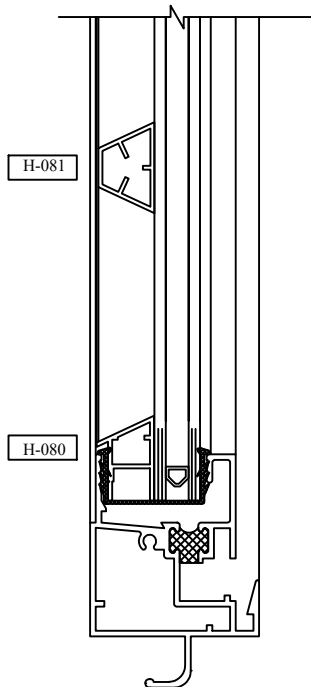

WRAP-AROUND CHANNEL GLAZING

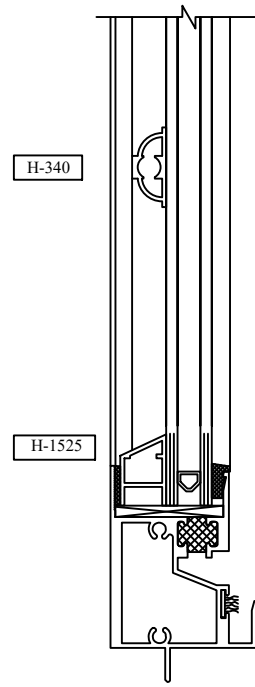

TAPE GLAZING

Half Scale Sections

WRAP-AROUND CHANNEL MUNTIN BASES

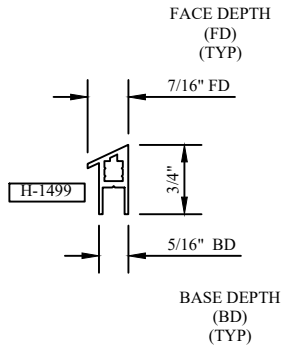

NOTE: ONLY TO BE USED
ON WRAP-AROUND CHANNEL PRODUCTS

MUNTIN BASE
H-1499

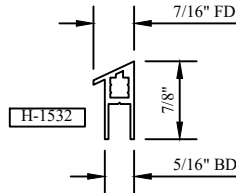

NOTE: ONLY TO BE USED
ON WRAP-AROUND CHANNEL PRODUCTS

MUNTIN BASE
H-1532

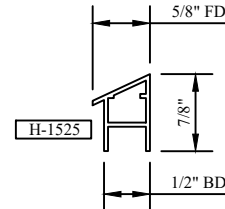

NOTE: ONLY TO BE USED
ON WRAP-AROUND CHANNEL PRODUCTS

MUNTIN BASE
H-1525

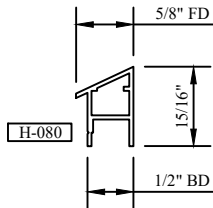

NOTE: ONLY TO BE USED
ON WRAP-AROUND CHANNEL PRODUCTS

MUNTIN BASE
H-080

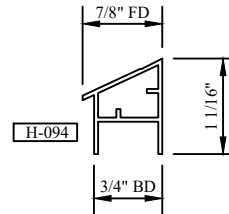

NOTE: ONLY TO BE USED
ON WRAP-AROUND CHANNEL PRODUCTS

MUNTIN BASE
H-094

STANDARD MUNTIN BASES

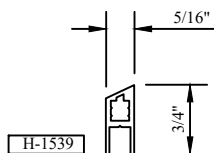

.312 MUNTIN BASE (FLUSH)
H-1539

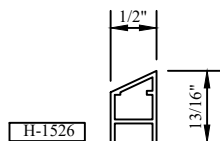

.500 MUNTIN BASE (FLUSH)
H-1526

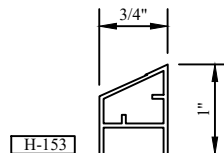

.750 MUNTIN BASE (FLUSH)
H-153

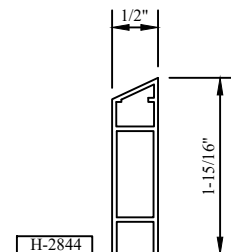

NOTE: ONLY TO BE USED
ON TR-9100 @ FIXED LITE VERTICALS

.500" MUNTIN BASE
H-2844

Half Scale Sections

STANDARD MUNTIN GRIDS

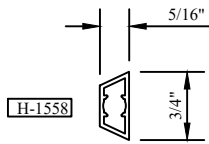

MUNTIN GRID
H-1558

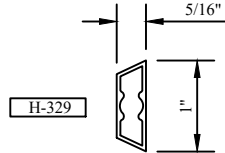

MUNTIN GRID
H-329

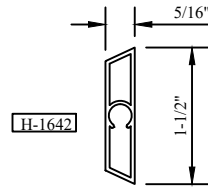

MUNTIN GRID
H-1642

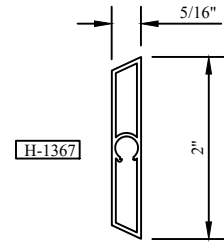

MUNTIN GRID
H-1367

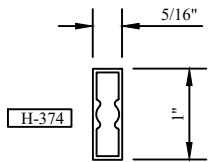

MUNTIN GRID
H-374

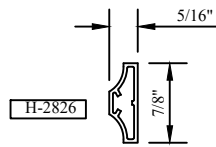

MUNTIN GRID
H-2826

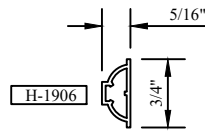

MUNTIN GRID
H-1906

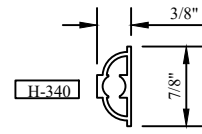

MUNTIN GRID
H-340

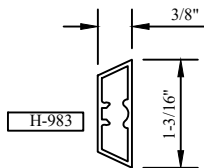

MUNTIN GRID
H-983

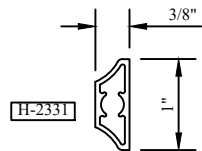

MUNTIN GRID
H-2331

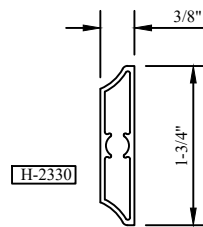

MUNTIN GRID
H-2330

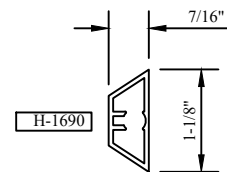

MUNTIN GRID
H-1690

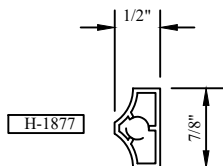

MUNTIN GRID
H-1877

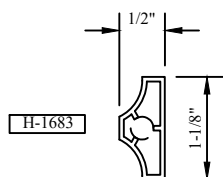

MUNTIN GRID
H-1683

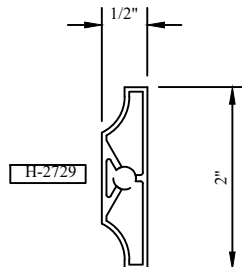

MUNTIN GRID
H-2729

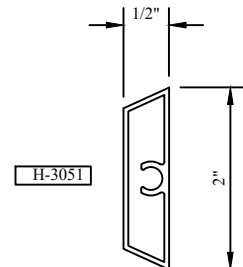

MUNTIN GRID
H-3051

Half Scale Sections

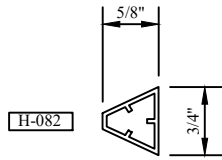

MUNTIN GRID
H-082

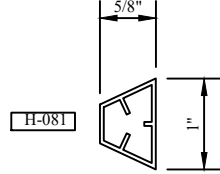

MUNTIN GRID
H-081

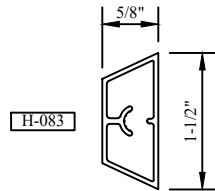

MUNTIN GRID
H-083

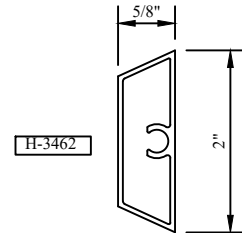

MUNTIN GRID
H-3462

INTERNAL MUNTIN GRIDS

ROLL-FORMED
.019" ALUMINUM
#30-1083 (MILL FINISH)

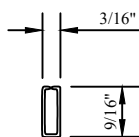

BETWEEN GLASS
MUNTIN FOR 1/2" AIR SPACE

STANDARD COLONIAL MUNTIN

ROLL-FORMED
.019" ALUMINUM
#30-1111 (MILL FINISH)

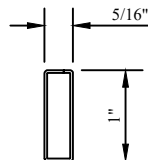

BETWEEN GLASS
MUNTIN FOR 3/4" AIR SPACE

1" COLONIAL MUNTIN

ROLL-FORMED
.019" ALUMINUM
#30-1112 (MILL FINISH)

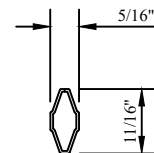

BETWEEN GLASS
MUNTIN FOR 3/4" AIR SPACE

PROFILE COLONIAL MUNTIN

Half Scale Sections

SASH DIVIDERS

USED ONLY IN WRAP-AROUND CHANNEL GLAZED PRODUCTS

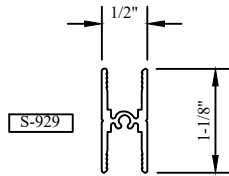

SASH DIVIDER FOR 1/4" GLASS
S-929

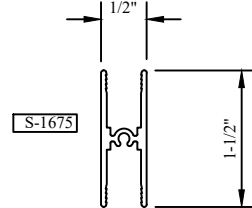

SASH DIVIDER FOR 1/4" GLASS
S-1675

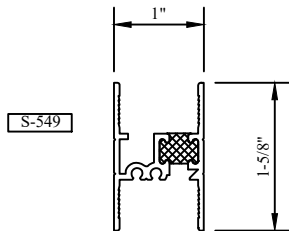

SASH DIVIDER FOR 3/4" GLASS
S-549

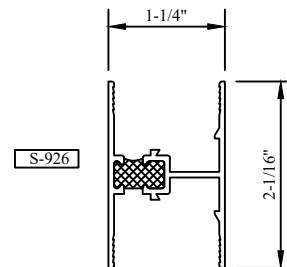

SASH DIVIDER FOR 1" GLASS
S-926

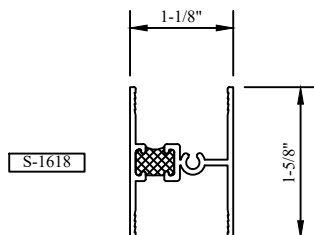

SASH DIVIDER FOR 7/8" GLASS
S-1618

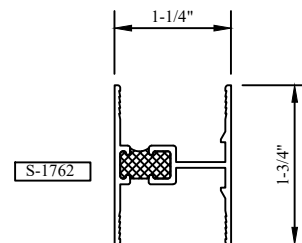

SASH DIVIDER FOR 1" GLASS
S-1762

Combinations 1 of 3

STANDARD MUNTIN BASE / GLASS COMBINATIONS
BY PRODUCT TYPE

PRODUCT	OVERALL INFILL POCKET	MUNTIN BASE	GLASS DEPTH
TR-700	1"	H-153	* 1/8"
TR-2000			
TR-3000		H-153	* 3/16"
TR-7100		H-153	1/4"
		H-1526	1/2"
		H-1539	11/16"
	1 1/2"	H-1526	1"
TR-3000	2"	H-1526	1 1/2"
TR-7100			
TR-9400	1"	H-153	1/4"
TR-9500		H-1526	1/2"
		H-1539	11/16"
TR-6300	1"	H-153	* 1/8"
TR-6800			
TR-400		H-153	* 3/16"
		H-153	1/4"
		H-1526	1/2"
		H-1539	11/16"
TR-9100	1"	H-1526	1/2"
		H-1526 **H-2844	1/2"

* NOTE: INTERIOR GLAZING GASKET CHANGES.
** NOTE: ONLY TO BE USED @ VERTICALS OF FIXED LITE

Combinations 2 of 3

WRAP-AROUND CHANNEL MUNTIN BASE / GLASS COMBINATIONS
BY PRODUCT TYPE

PRODUCT	OVERALL INFILL POCKET	MUNTIN BASE	GLASS DEPTH
TR-5000 TR-5020	3/4"	H-1525	1/4"
		H-1499	7/16"
TR-6000	3/4"	H-080	1/4"
		H-1532	7/16"
TR-5700	7/8"	H-094	1/8"
		H-1532	9/16"
TR-9000	1"	H-094	1/4"
		H-080	1/2"
		H-1532	11/16"

STANDARD MUNTIN BASE / MUNTIN GRID COMBINATIONS

MUNTIN GRID

MUNTIN GRID DEPTH			5/16"								3/8"	7/16"	1/2"	5/8"				
MUNTIN BASE DEPTH		MUNTIN BASES		H-1558	H-329	H-1367	H-374	H-982	H-1906	H-1642	H-340	H-983	H-1690	H-1877	H-1683	H-082	H-081	H-083
BD	FD			X	X	X	X	X	X	X	N/A	N/A	N/A	N/A	N/A	N/A	N/A	N/A
5/16"	5/16"	H-1539			X	X	X	X	X	X	X	N/A	N/A	N/A	N/A	N/A	N/A	N/A
1/2"	1/2"	H-1526			X	X	X	X	X	X	X	X	X	N/A	N/A	N/A	N/A	N/A
3/4"	3/4"	H-153			X	X	X	X	X	X	X	X	X	X	X	X	X	X

(N/A) COMBINATIONS NOT APPLICABLE

(BD) BASE DEPTH

(FD) FACE DEPTH

WRAP-AROUND CHANNEL MUNTIN BASES / MUNTIN GRID COMBINATIONS

MUNTIN GRID

MUNTIN GRID DEPTH			5/16"							3/8"	7/16"	1/2"	5/8"					
MUNTIN BASE DEPTH		MUNTIN BASES	H-1558	H-329	H-1367	H-374	H-982	H-1906	H-1642	H-340	H-983	H-1690	H-1877	H-1683	H-082	H-081	H-083	
BD	FD																	
5/16"	7/16"	H-1499		X	X	X	X	X	X	X	X	X	X	N/A	N/A	N/A	N/A	N/A
		H-1532		X	X	X	X	X	X	X	X	X	X	N/A	N/A	N/A	N/A	N/A
1/2"	5/8"	H-1525		X	X	X	X	X	X	X	X	X	X	X	X	X	X	X
		H-080		X	X	X	X	X	X	X	X	X	X	X	X	X	X	X
3/4"	7/8"	H-094		X	X	X	X	X	X	X	X	X	X	X	X	X	X	X

(N/A) COMBINATIONS NOT APPLICABLE

(BD) BASE DEPTH

(FD) FACE DEPTH